

---

# Operation Manual

## Kamio<sup>®</sup>

### KAM6E



# Kamio 6E Kit (On-Camera/ENG)

The **Kamio 6E** is a ring-light that clips to the lens of film or video cameras. It is powered by an on-board 12-24VDC dimming ballast (**BAL-149X**). Main application is for front-fill beauty light for ENG stand-up interviews.



## **KIT-KAM6E**

Kamio 6E Kit, (On-Camera/ENG)

### **Kit Contents:**

- 1 Kamio 6E Ring-Light (112mm) w/ 3ft Harness
- 1 Kamio 12VDC On-Camera Ballast
- 1 Ballast Mount
- 1 Baby Shoe Mount
- 1 Travel Case

### **Dimensions:**

21 x 7.5 x 17"  
(53.5 x 19 x 43cm)

### **Weight:**

10 lb  
(4.5kg)

# Kamio 6E System (On-Camera/ENG)



## **SYS-KAM6E**

Kamio 6E System, (On-Camera/ENG)

### **System Contents:**

- 1 Kamio 6E Ring-Light (112mm) w/ 3ft Harness
- 1 Kamio 12VDC On-Camera Ballast
- 1 Ballast Mount
- 1 Baby Shoe Mount

# Kamio Assembly

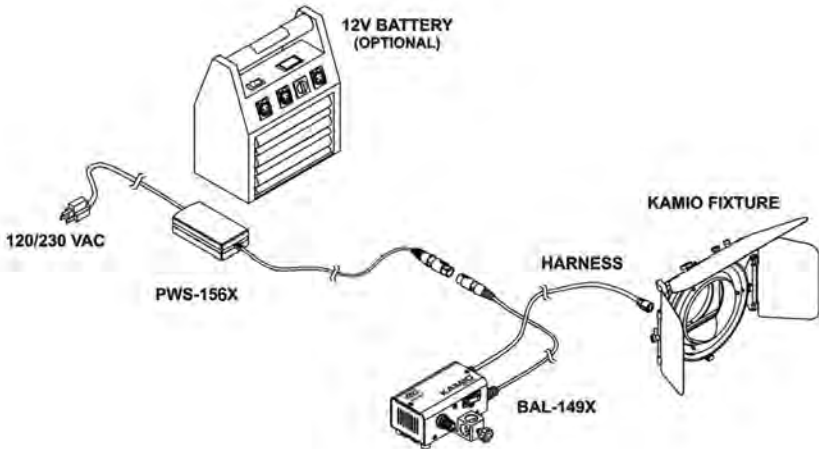
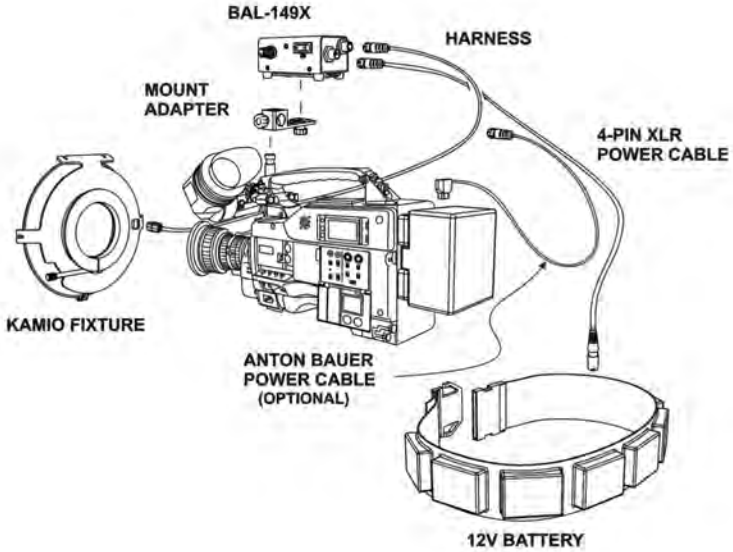

# Kamio Detail

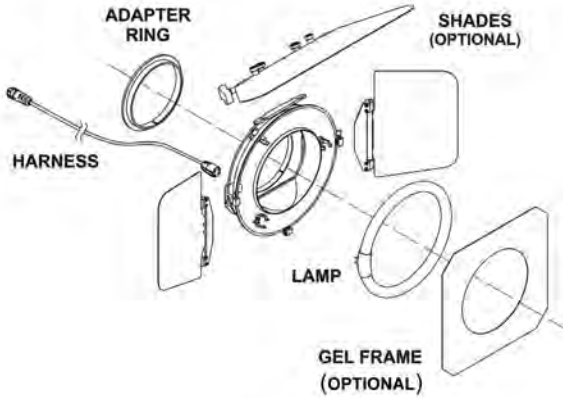

## Mounting Kamio to Lens

The **Kamio 6E** Ring-Light is designed to mount directly onto the camera lens. An expandable clamping ring is designed to fit lenses with an outside diameter of 112mm (e.g. Panavision Primo Primes). Turn the locking screw to clamp down on the lens. Lens adapter rings are available to accommodate various smaller lens diameters. (See “Accessories” for details.)



**Note: The Kamio is only recommended for fixed barrel lenses.** Fixed barrel lenses are designed to support the weight of the Kamio and keep the fixture properly oriented.

## Changing Lamps

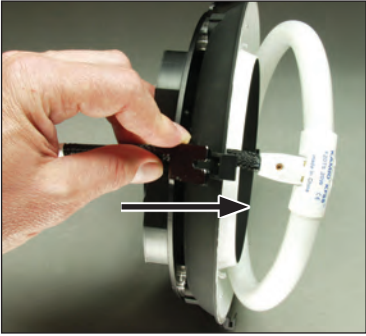

Extract the lamp by pushing the lamp harness through the reflector. The lamp will clear the reflector making it easier to grasp.

## Applying Gel Filters

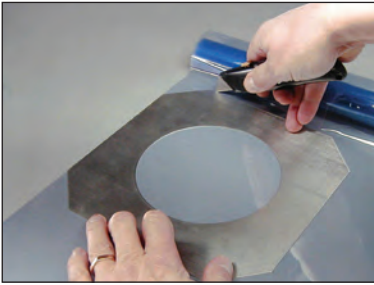

### IMPORTANT:

*Prior to using the filter frame, remove translucent protective plastic coating from both sides.*

Use the steel gel template to cut a filter to the correct size. The filter is then taped to the transparent filter frame.

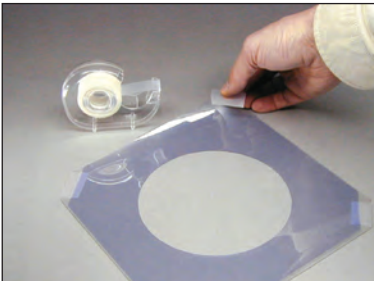
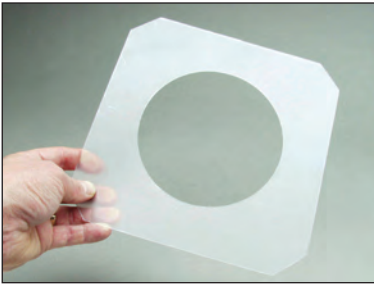

# Ballast Operation

## Warning! To Ensure Proper Operation

ALWAYS TURN **OFF** THE BALLAST BEFORE connecting or disconnecting lamps, harnesses or head extension cables. Maximum distance is 30ft (2 x 15ft cables).

## Ballast Operation

The Kamio Ballast (**BAL-149X**) operates remote from the fixture. Connect the Kamio lamp harness to the extension cable or the Ballast, making sure to rotate the locking ring until it clicks into the locked position. After the lamps are properly installed, the Ballast can be turned on. Avoid operating in temperatures above 125°F (51°C).

(Note: The dimmer should be full up when striking the lamp. Once the lamp has come up to full temperature, in 3-5 minutes, then dim to the desired light level.)

It is normal for the lamp to take 1-2 seconds to ignite. In cold temperatures the Ballast may take longer to ignite the lamp. If it does not ignite within 5 seconds, switch the ballast to OFF and try again. If the lamp does not strike after 2 or 3 attempts, turn Ballast off, check that the harness or any extension connections are secure and restrike.

**CAUTION:** For AC operation use the PWS-156X universal power supply. Do not operate Camera and Kamio with a Camera Battery Charger. The combined load exceeds the Charger's capacity and will result in the Charger failing.

# Ballast Controls

END VIEW



A

B

SIDE VIEW



C

D

E

- A) **Power Input:** Connects to 12VDC power cable (4-Pin xlr) or 24VDC cable (3-Pin xlr).
- B) **Lamp Output:** Connects to lamp Harness cable.
- C) **Dimmer Control:** Adjusts light level of the Lamp.
- D) **Trim:** Adjusts the bottom end of the dimming curve.
- E) **Power Switch:** On/off power switch. Indicator lights up green when power is applied.

# Mounting Ballast



Mounting Bracket, **MTP-141**, is required to mount the ballast to a baby pin. Loosen thumbscrew on the **MTP-141** sufficiently to allow the flange to insert into the track on the underside of the ballast.



Baby Shoe Adapter, **MTP-141S**, is used to mount the Ballast to a camera equipped with a hot shoe receptacle. Slide the flange of the **MTP-141S** into the hot shoe receptacle on the camera. Lock the pin by screwing down the thumbscrew.



An optional Baby Mount w/ 1/4" Screw (**MTP-141P**) is used to mount the Kamio Ballast to cameras equipped with a 1/4" screw hole instead of a hot shoe. Another mount option is the Ballast Clamp with Baby Pin (**MTP-141C**). Both can be used with the **MTP-141**.



Mount the **BAL-149X** to the baby pin as shown.



# Lamps and Adapter Rings



**06C-K32** 6" Kino KF32  
**06C-K55** 6" Kino KF55



**KAM58/85** 58-85mm Threaded ring adapter  
**KAM72/85** 72-85mm Threaded ring adapter  
**KAM80** 80mm / Fits Zeiss Super Speed Lenses  
 Canon 16X Mechanical Zoom  
**KAM82** 82mm / Fits Fuji 16x5.5/13x5.5/.8x Converter  
**KAM84** 84mm / Fits Panavision Digital Primes  
**KAM85** 85mm / Fits many Canon & Fujinon Zooms  
**KAM86** 86mm Lens Adapter  
**KAM87** 87mm / Fits Zeiss T3 10:1 Zoom  
**KAM89** 89mm / Fits Canon XL1, 16X Auto Zoom  
 and 3X Auto Zoom  
**KAM93** 93mm Lens Adapter  
**KAM94** 94mm / Fits Canon XL2  
 20 x 5.4 – 108mm Zoom  
**KAM95** 95mm / Fits Zeiss Ultra & Canon Zooms  
**KAM97** 97mm Lens Adapter  
**KAM98** 98mm Lens Adapter  
**KAM100** 100mm / Fits Fujinon 17 (8-160mm Zoom)  
**KAM102** 102mm / Fits Panavision Digital Zooms,  
 25-112mm SDZT, 6-27mm SDZW  
**KAM104** 104mm / Fits Arri Digital Primes,  
 Angenieux 14x8  
**KAM110** 110mm / Fits Cooke Primes

**Note:** 112mm clamp ring permanently fixed to Kamio fixture. Fits Panavision® Primo Primes.



# Kit Components and Accessories

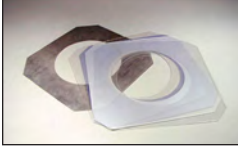

**GFR-KAM6** Kamio Gel Frame  
**GFR-KAM6T** Kamio Gel Frame Template



**HAR-KAM6** Kamio Lamp Harness, 3ft



**KAM6L** Kamio 6 Barndoor, Long

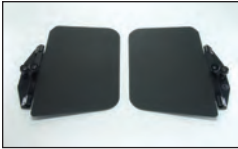

**KAM6S** Kamio 6 Barndoor, Short (2pk)



**MTP-141** Kamio Ballast Mount (16mm)



**MTP-141C** Kamio Ballast Clamp w/ Baby Pin (16mm)



**MTP-141P** Kamio Ballast Baby Mount w/ 1/4" Screw (16mm)



**MTP-141S** Kamio Ballast Baby Shoe Mount (16mm)



**PWC-141A** Kamio to Anton Bauer Battery Adapter, 3ft

Caution: For AC operation of Camera and Kamio, do not use Battery Charger. The combined load exceeds the Charger's capacity. Use Kino Flo's AC Power Supply **PWS-156X** for AC operation of Kamio Only.



**PWC-141X** Kamio to 4-Pin xlr, 8ft



**PWS-156X** 6.6 Amp Universal VAC Power Supply w/ 4-Pin xlr (Edison and European IEC power cords included)



**X04-K15** Kamio Head Extension Cable, 15ft

## Cases



**KAS-KAM6-C** Kamio 6 Basic Travel Case

# Ballast Specifications



**BAL-149X**

## **BAL-149X**

Kamio Ballast, 12-24VDC w/ 4-Pin xlr

**Input Voltage:** 12-24VDC

**Power Rating:** 12VDC = 30 Watts @ 2.5 amps

15VDC = 30 Watts @ 2.0 amps

24VDC = 31 Watts @ 1.3 amps

**Switching:** On/Off

**Output Frequency:** 25 kHz

**Size:** 4.7 x 2.5 x 2"

(11.9 x 6.4 x 5.1cm)

**Weight:** 1.0 lb (0.4kg)

**Weight w/ Mount:** 1.2 lb (0.5kg)

# Ballast Specifications



**KAM6E**

## **KAM6E**

Kamio 6E (On-Camera/ENG)

**Fixture Dimensions:** 10 x 9 x 2"

(25.5 x 23 x 5cm)

**Opening:** 112mm

**Mount Type:** Clip onto lens

**Weight w Lamp:** 1.0 lb (0.5kg)

**Weight w/ Lamp  
and Barndoors:** 2.07 lb (0.94kg)

For latest Warranty information and Certifications,  
see Kino Flo website at [www.kinoflo.com](http://www.kinoflo.com).

**Environmental: Disposal of Old Electrical & Electronic Equipment.**



This symbol on the product or on its packaging indicates that this product shall not be treated as household waste. This product is made of recyclable materials and should be disposed of in accordance with local and state regulations.

---

Kino Flo, Inc. 2840 N. Hollywood Way, Burbank, CA 91505, USA  
Tel: 818 767-6528 website: [www.kinoflo.com](http://www.kinoflo.com)